

ASSEMBLY INSTRUCTIONS

#9733, #5433, #9734

INSTALLATION



STEP 1 - INSTALL HANDLE INTO FRAME.

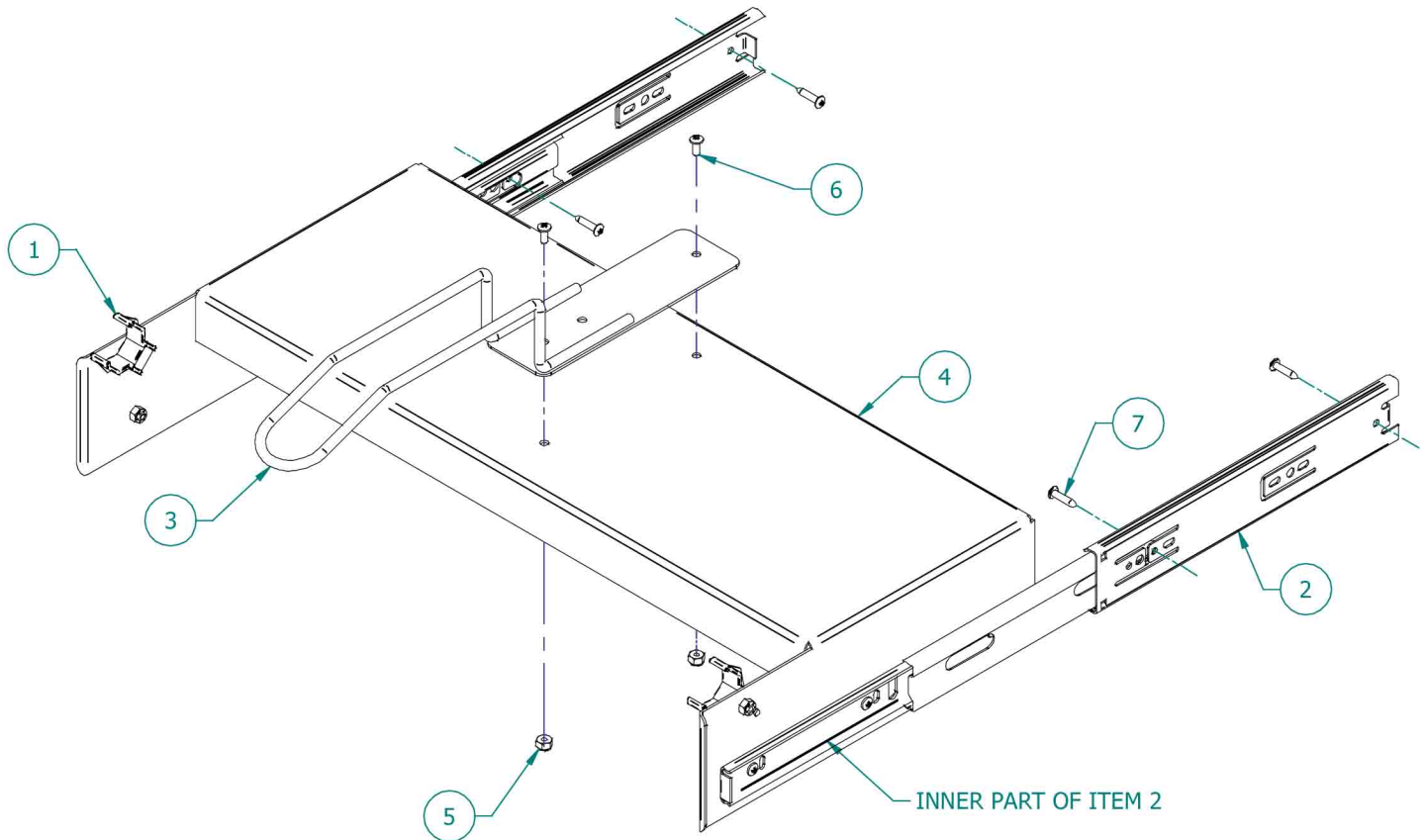

4	HARDWARE	SCREW, #8 X 3/4" WOOD PAN HD PHILLIPS	GRADE 2, ZINC	7
10	HARDWARE	SCREW, #8-32 X 3/8" PAN HD PHILLIPS	GRADE 2, ZINC	6
10	HARDWARE	NUT, #8-32UNC HEX NYLON-INSERT LOCKNUT	STEEL, ZINC	5
1	SEE TABLE 1	FLEX-COLLECT HANGERBAR CADDY	--	4
1	22241	HANDLE WELDMENT	--	3
2	21060	DRAWER SLIDE, 3-PC TELESCOPING SIDE-MOUNT SIQUAR 10" (254mm) EXTENSION 100LB PRECISION BALL-BEARING (SIQUAR#BS46B10) OR EQUIVALENT	--	2
2	21010	HANGERBAR CLIP	--	1
QTY. REQ'D	PART OR IDENTIFYING NO.	NOMENCLATURE OR DESCRIPTION	MATERIAL SPECIFICATION	ITEM NO.

ASSEMBLY INSTRUCTIONS

#9733, #5433, #9734

INSTALLATION



POSITION AND ATTACH SLIDES TO CABINETS AS RECOMMENDED BELOW.

NOTE: 1) IF USING HANGERS OF DIFFERENT SIZE AS SHOWN, ADJUST THESE DIMENSIONS ACCORDINGLY.

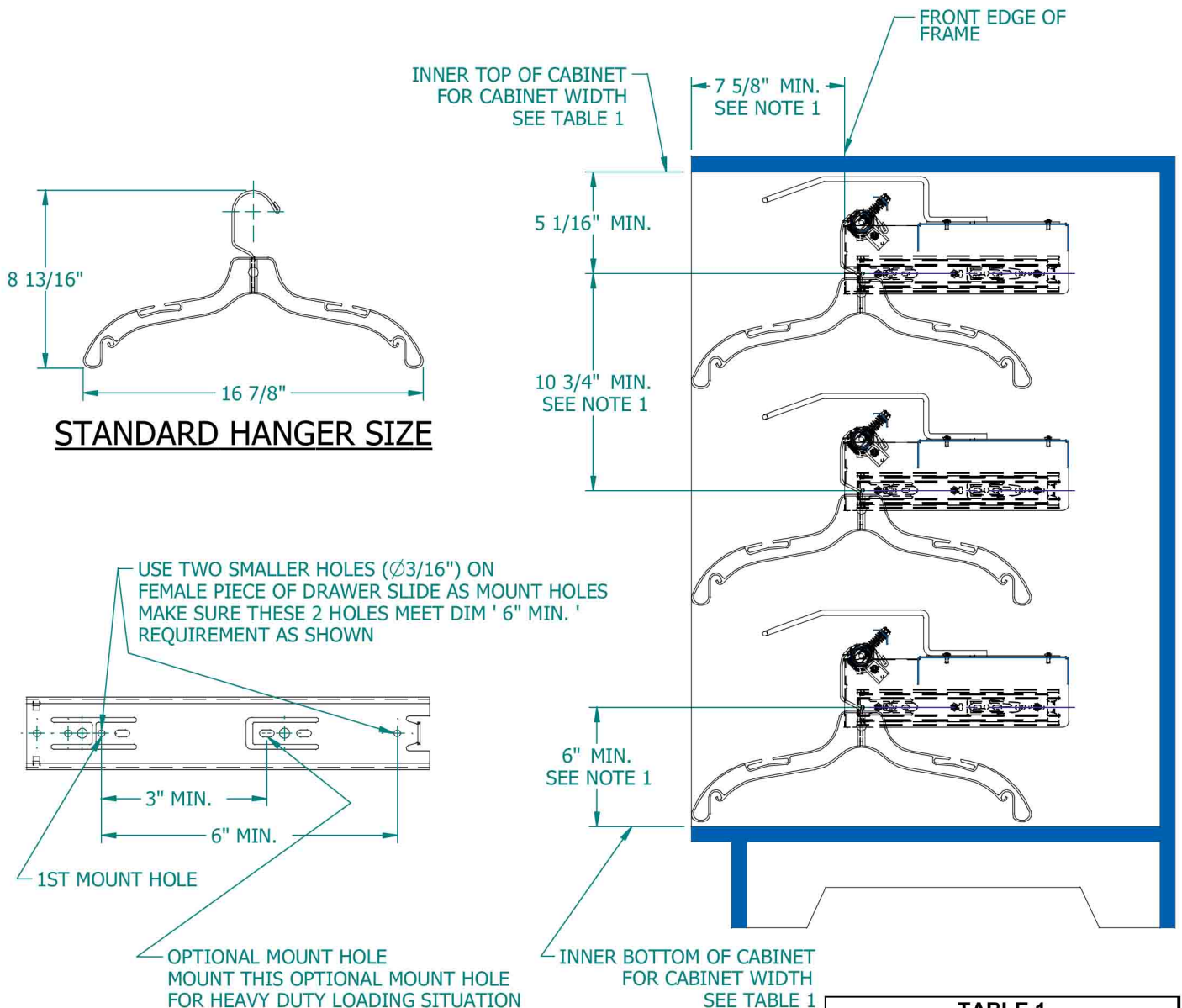

USE TWO SMALLER HOLES (Ø3/16") ON FEMALE PIECE OF DRAWER SLIDE AS MOUNT HOLES MAKE SURE THESE 2 HOLES MEET DIM ' 6" MIN. ' REQUIREMENT AS SHOWN

OPTIONAL MOUNT HOLE MOUNT THIS OPTIONAL MOUNT HOLE FOR HEAVY DUTY LOADING SITUATION MAKE SURE :
 a) THIS HOLE IS EITHER SLOT HOLE OR SMALLER (3/16") CIRCULAR HOLE
 b) THIS HOLE IS '3" MIN.' AWAY FROM 1ST MOUNT HOLE AS SHOWN

TABLE 1		
CABINET WIDTH		
ITEM	INCHES	mm
9733	21 1/2	545
5433	25 1/8	638
9734	30 1/2	774

Palay Display Industries, Inc.

10901 Louisiana Ave S Ste 106

Bloomington, MN 55438

www.palaydisplay.com